

INSTALLATION MANUAL

HIGH CAM SHAFT

300-4030000

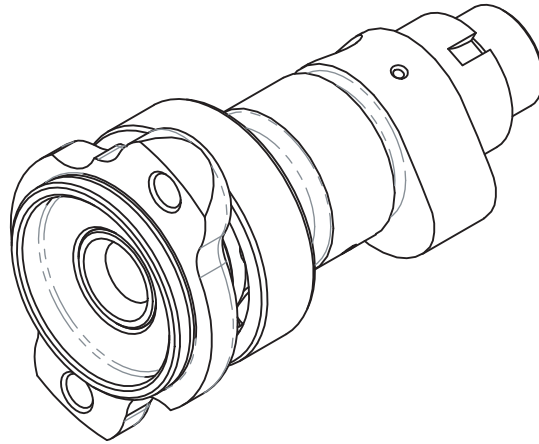

Application Z125 PRO

- Thank you for purchasing Kitaco product. Read and understand the instruction before installing.
- There are special tools required to install this kit.
- Use this instruction for setting manual afterwards.
- ※ Keep this instruction since it is not included in repair parts.

ATTENTIONS (MUST READ)

- Race use only. Note that racing parts are not covered under warranty.
- We are not responsible for damages and accidents caused by assembling mistake and improper setting.
- If running without the right setting, you cannot improve and may cause seizure and damage. Make sure to make the right setting for each engine.
- Follow the instructions and install correctly. Do not modify the way which is not listed, or it will cause damage and trouble.
- Ask a mechanic or a specialist at a specialty shop for assembling and setting if you do not understand the role of the surrounding parts.
- Bolts and nuts may get loosen by engine vibration. Make sure to check that each part of bolts and nuts are not loose before running.
- Clean each parts by parts cleaner and use air duster to check whether the oil line is choked up.
- Oil the parts with engine oil when assembling.
- Do not check the sparking of spark plug outside of the cylinder head. There are dangerousness of explosion.
- Refer to the KAWASAKI service manual for each vehicle when installing.



This sheet is for the person who has basic knowledge for maintenance.
Do not operate if you do not have skill and knowledge.



FLAMMABLES
Flammable high gasoline is used during operation.
The use of products causing fire or smoke is strictly prohibited.



HIGH VOLTAGE
Wear insulated gloves when checking the sparking outside the cylinder.



TOXIC
Toxic, highly-volatile gasoline is used during operating.
Make sure to ventilate the room and do not operate for hours in a hermetically closed room.



EXTREMELY HOT
Do not touch the engine parts (cylinder, crankcase, muffler, engine oil, etc...) right after engine operation.
Make sure to start the installation after the engine parts are completely cool.

INSTALLATION PROGRESS

With this camshaft engine output improves by changing valve timing / valve lift.
OEM decompression parts installable.

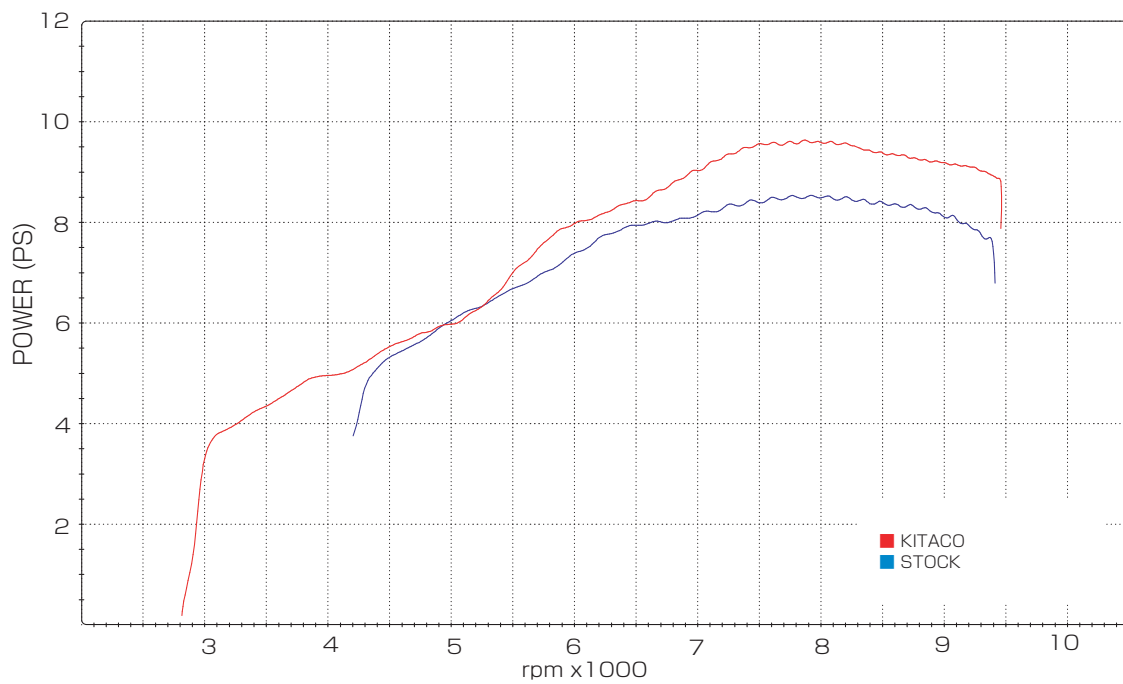
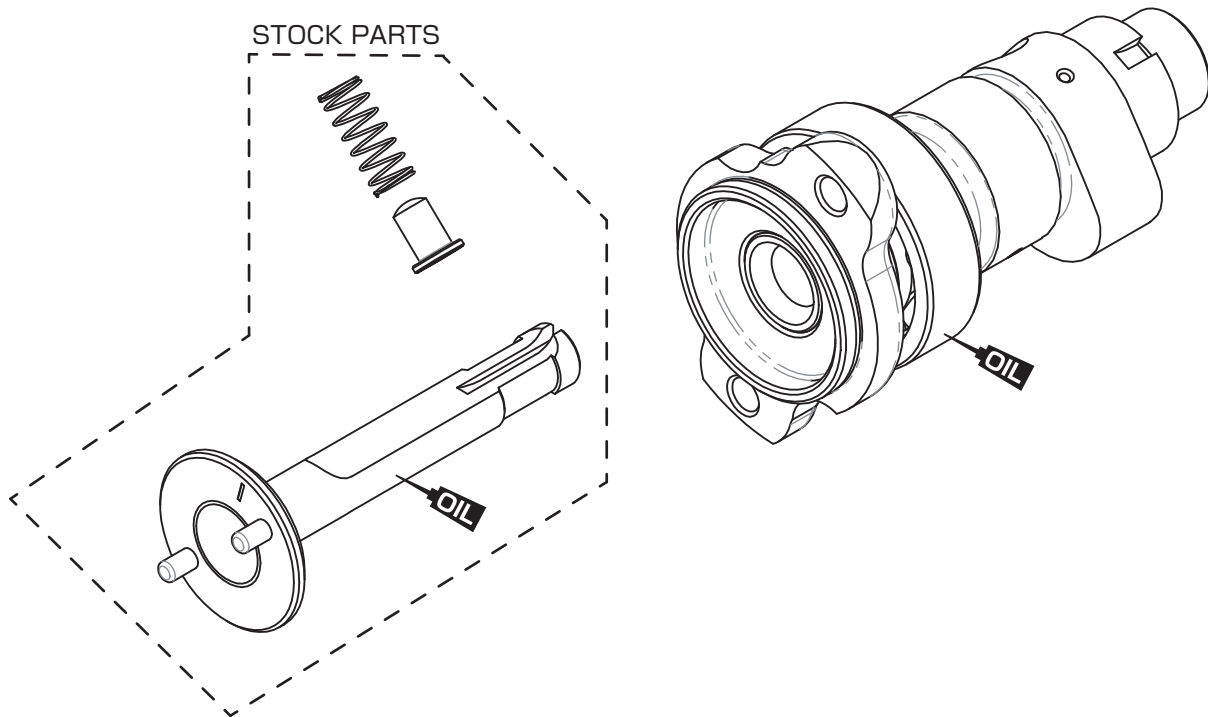

SPECIAL TOOLS

TORQUE WRENCH 1/4
(6~30 N·m)
674-0100100



FEELER GAUGE

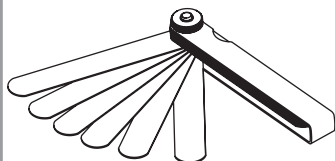

Follow KAWASAKI SERVICE MANUAL instruction.

Remove flange bolt M6x20 (4 pcs), to remove Camshaft sprocket cover.

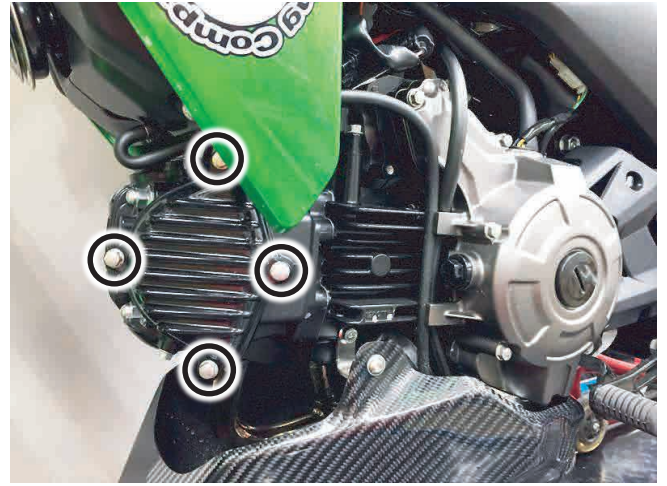

Remove Timing Inspection Cap & Alternator Rotor Nut Cap.

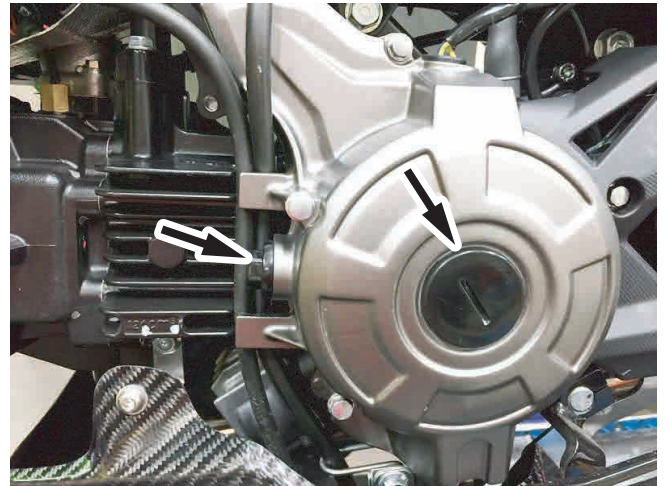

Turn the alternator rotor nut counterclockwise to align the "T" mark line [⇒] on the rotor with the notch of the alternator cover.

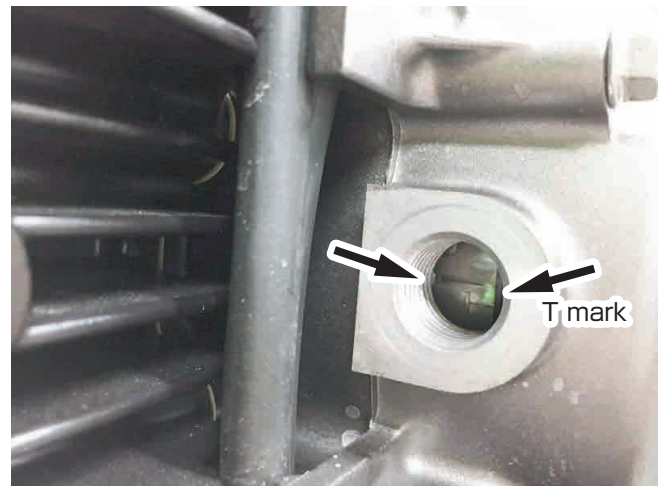

Align camshaft sprocket marking line with cylinder head notch.

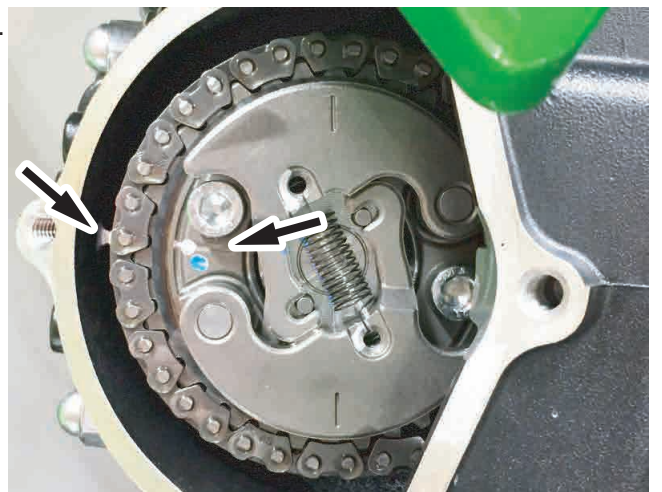

Keep crankshaft stable to remove camshaft sprocket.



Remove valve adjusting cap
Loosen rocker shaft stopper screw M6x15 (2 pcs)
Remove rocker shaft stopper.

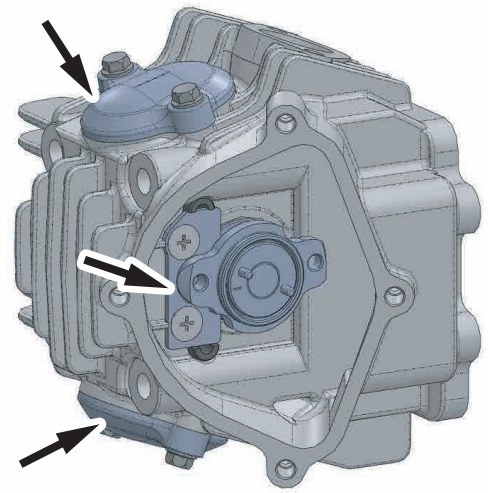

Remove camshaft.

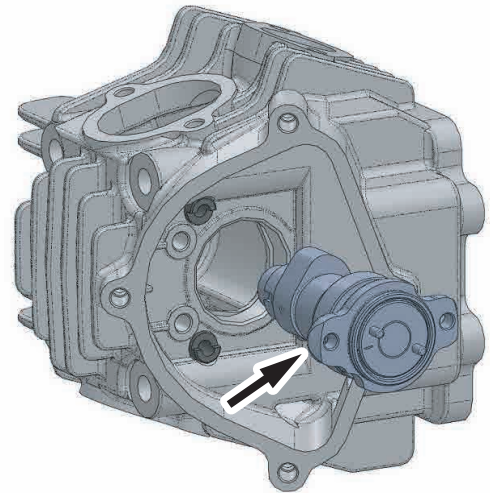

Remove decompression parts out of STOCK CAMSHAFT.
Uses plier & tweezers to remove & install.

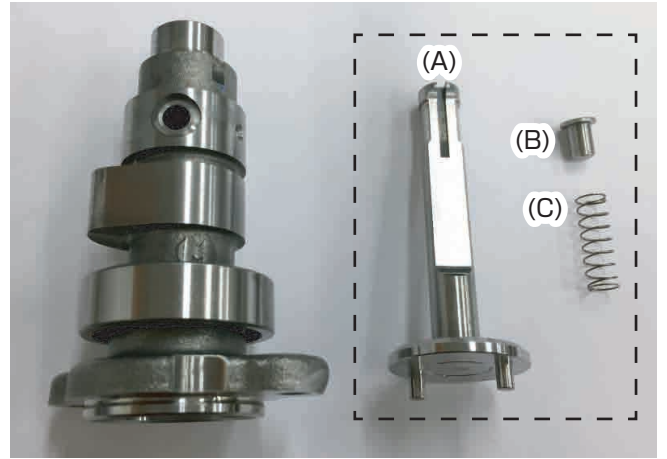

With a plier, pull out the part [A]
Be careful not to hurt the part.
With a plier, pull out the part [C]



Install decompression parts to Kitaco high camshaft.
Press [C] with tweezers to install it inside the camshaft.
Install [B] inside [C] to correct the direction.

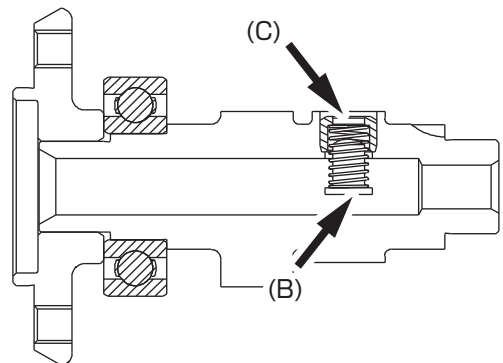
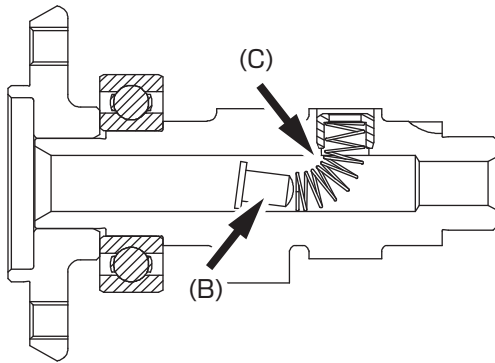

While pushing [B][C] up with tweezers, insert [A].

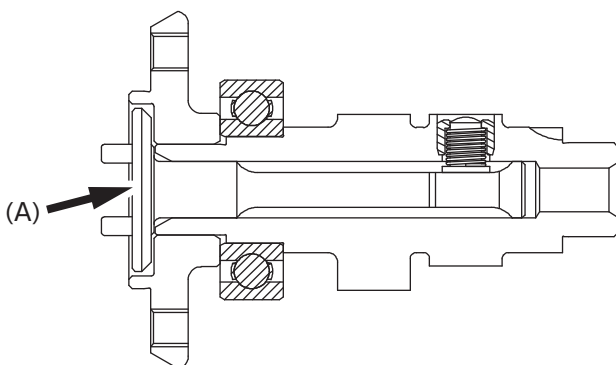

<https://youtu.be/i9dvnEsedtc>

Insert camshaft into cylinder head.
Apply to engine oil to bearing and cam shaft lobes.

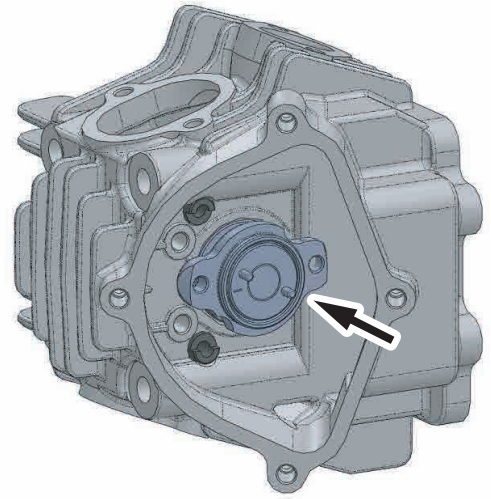

Install rocker shaft stopper &
rocker shaft stopper screw M6x15 (2 pcs)

TORQUE
5.2 N·m (0.53 kgf·m)

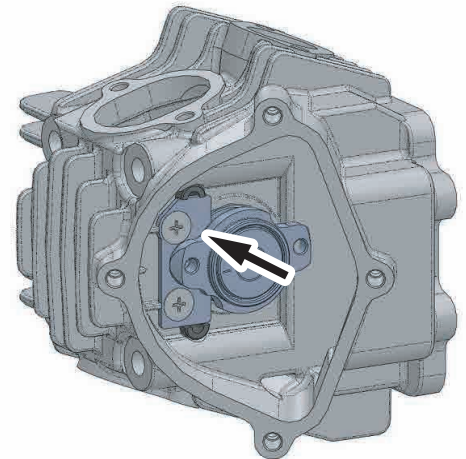

Remove chain tensioner cap bolt.



Turn push rod clockwise with minus driver to loosen tensioner.

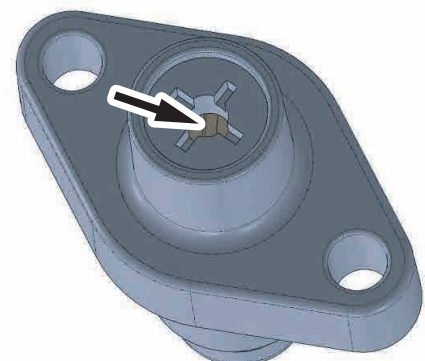

Turn the alternator rotor nut counterclockwise to align the "T" mark line on the rotor with the notch of the alternator cover.

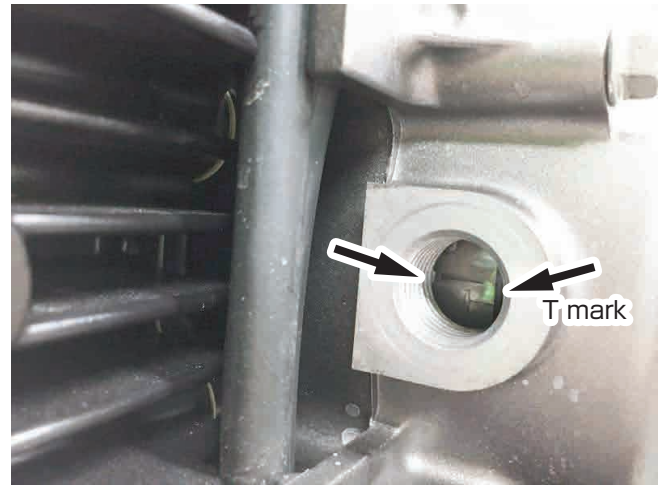

Align marking line of camshaft sprocket with notch of cylinder head.

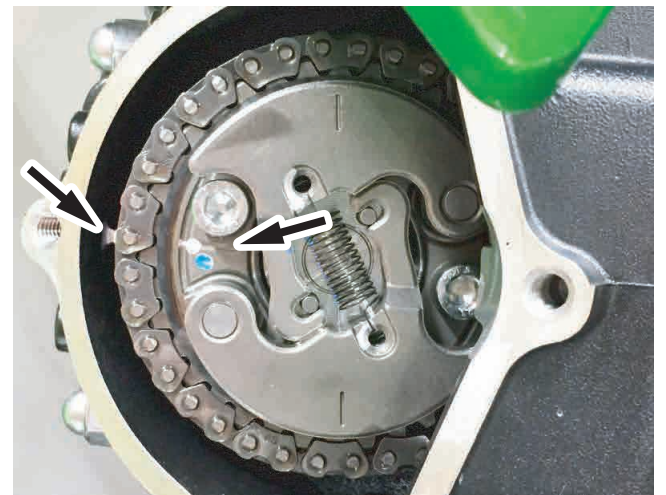

While camshaft is aligned, tighten camshaft sprocket bolt M6x10.

TORQUE	
12 N·m (1.2 kgf·m)	



Turn the crankshaft so that the piston comes to TDC (top dead center), to adjust the valve clearance.

VALVE CLEARANCE	
INTAKE	0.06 ± 0.02mm
EXHAUST	0.10 ± 0.02mm

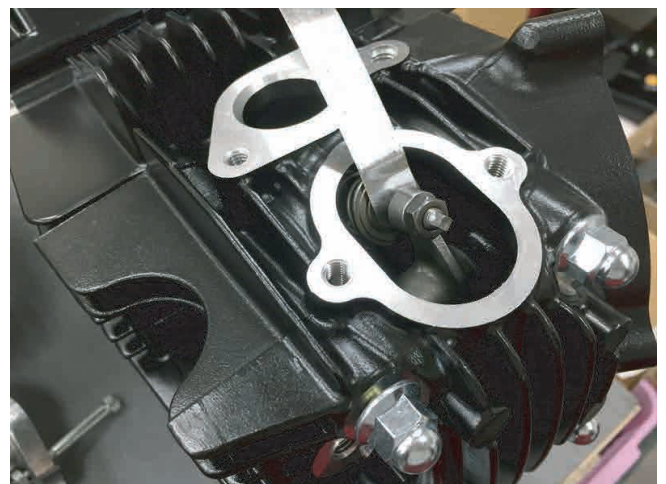

Apply to engine oil to adjust screws to install valve adjusting cap.

Locknut TORQUE
8.8 N·m (0.9 kgf·m)

Valve Adjusting Screw Locknut

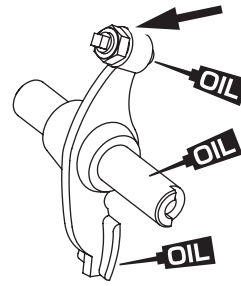

Cover Bolt TORQUE
5.2 N·m (0.53 kgf·m)

Valve Adjusting Cap

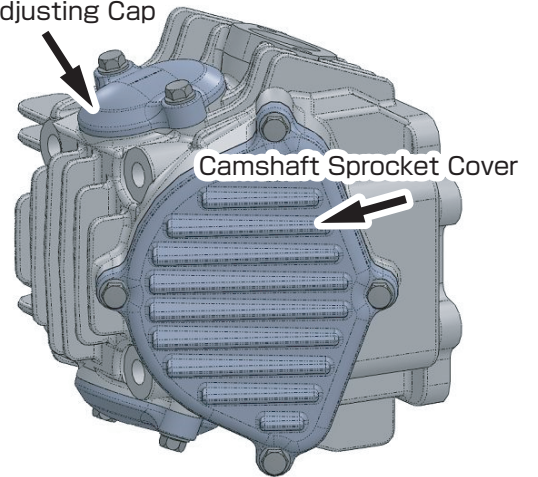

● Kitaco assumes no responsibility for accuracy, completeness or sufficiency of the information contained in this document.

